

Lyncrest Elementary School

Primary Service: Architecture
Type: Educational (E.S.)
Owner/Client: Fair Lawn Board of Ed.
Location: Fair Lawn, New Jersey
Cost: \$1,638,000
Square Footage: 4,703 sf
Completion Date: September 2006
Contact: Bruce Watson
Superintendent
201.794.5510



PROJECT #2.2369.60



Media Center

Project Scope:

LAN provided architectural and engineering services to the Fair Lawn Board of Education for a new addition to the existing Lyncrest Elementary School. The addition included an enlarged Nurse's office, a Reach Room, two Small Group Instruction Rooms, a Conference Room, a Media Center with a computer area, and a Child Study Team Office. Interior renovations consisted of converting the existing Media Center to standard classrooms.

Measures were taken to match the brickwork of the existing building as closely as possible. Due to tight site constraints and an L-shaped plan, the addition was placed radially between the two arms. This minimized the impact on the existing playground area while providing more space. Care was given to the plan to provide the maximum amount of daylight to the new spaces while maintaining the daylight levels in the existing classroom spaces.

Services Performed:

- Architectural Design and Construction Documents
- Civil, Structural Mechanical and Electrical Engineering
- Cost Estimating
- Construction Administration and Observation

Program Highlights:

- New Construction/Renovation
- Two Small Group Instruction Rooms
- New 1,651 SF Media Center
- New Child Study Team Office
- New Reach Room
- New Nurse's Office
- New Small Conference Room
- Two Reclaimed Classrooms



Media Center Lighting/Ceiling Details

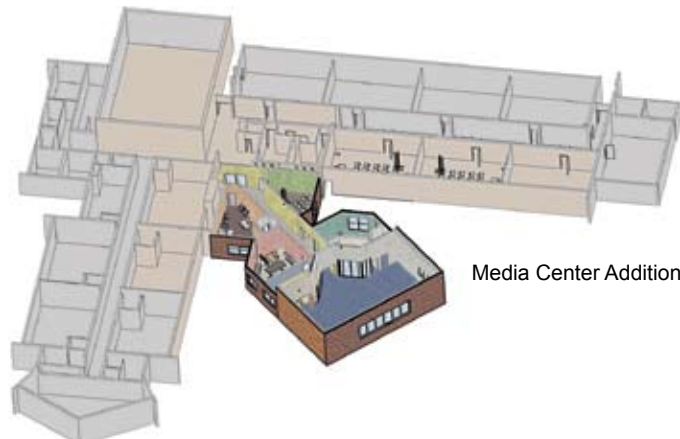

Media Center Addition

LAN

LAN ASSOCIATES
ENGINEERING ■ PLANNING ■ ARCHITECTURE ■ SURVEYING

Since 1965

ENGINEERING ■ PLANNING ■ ARCHITECTURE ■ SURVEYING