

John Y. Dater School

Primary Service: Architecture
Type: Educational (K-12)
Owner/Client: Ramsey Board of Ed.
Location: Ramsey, New Jersey
Cost: \$18,500,000
Square Footage: 71,488 sf
Completion Date: January 2005
Contact: Dr. Roy Montesano
Superintendent
201.785.2300



PROJECT #2.2102.67



Rendering of John Y. Dater School - Front Perspective

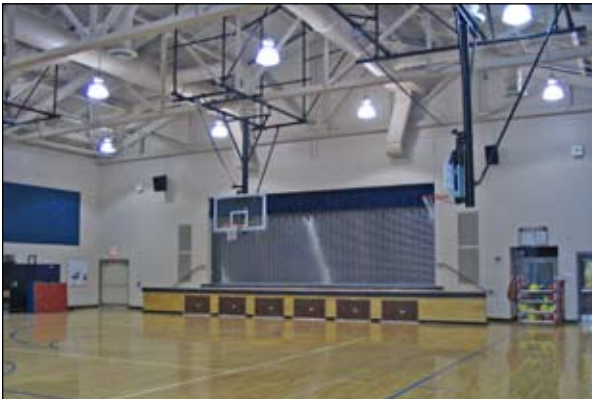

Gymnasium

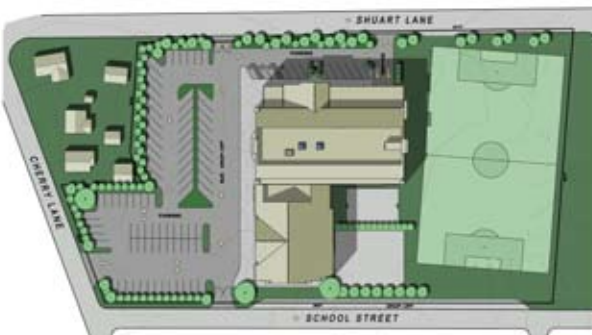

Site Plan Rendering

Project Scope:

LAN is the Architect and Engineer of Record for the design of the new John Y. Dater Elementary School in Ramsey, New Jersey. The John Y. Dater School cost nearly \$18.5 million to build and will measure approximately 71,000 square feet. Construction of the new school has been completed on the same site as the original Elementary School. The existing Elementary School was demolished upon the completed construction of the new Elementary School - offering various community, site and building improvements. The compact building footprint and 3-story design of the John Y. Dater School will maximize the available green space and reduce impervious surface run-off. An on-site retention area was created for storm water management.

The Ramsey BOE is anticipating a growing population of 700 students. Since the existing Elementary School is a grade K-3 facility, school redistricting became part of the referendum plan. The new John Y. Dater School is a grade 4-5 facility. The planning process of the new school was reactive to the needs of the community as expressed in various workshops and PTA meetings. LAN worked with the School Board to develop long-range facility plans, educational specifications, conceptual designs and cost estimates. LAN provided assistance to obtain state funding and Department of Education approvals and assisted with the referendum process. The overall building envelope meets or exceeds all of the State of New Jersey Energy Code requirements & performance standards. The energy efficient design of the John Y. Dater School will provide long term utility savings. The new John Y. Dater School will feature a healthy, safe and productive environment for both teachers and students of the nearly 300 year-old thriving New Jersey community.

Services Performed:

- Boundary, Topographic and Utility Surveys
- Geotechnical Investigations
- Architectural Design & Documentation
- Civil, Structural, Mechanical & Electrical Engineering
- Cost Estimating
- Construction Administration & Observation
- Preparation of E.O. #215 Reports

Program Highlights:

- 71,000 SF of New Construction
- 22 Standard Classrooms & Special Education Classrooms
- 2,800 SF Media Center
- Cafeteria & Kitchen
- Gymnasium & Athletic Fields
- Published in 2007 - *Learning by Design*

LAN

LAN ASSOCIATES
ENGINEERING ■ PLANNING ■ ARCHITECTURE ■ SURVEYING

Since 1965

ENGINEERING ■ PLANNING ■ ARCHITECTURE ■ SURVEYING